

**JOINT APPLICATION AND NOTIFICATION
U.S. ARMY CORPS OF ENGINEERS
MISSISSIPPI DEPARTMENT OF MARINE RESOURCES
MISSISSIPPI DEPARTMENT OF ENVIRONMENTAL QUALITY/OFFICE OF POLLUTION
CONTROL**

Applicant: James Embry
Mailing Address: 10122 Lagan Street
Bay St. Louis, MS 39520
Phone Number: [REDACTED]
Email Address:
[REDACTED]

Agent: Ferrill's Marine Construction,
LLC - Linda Ferrill
Mailing Address: 9234 Kiln Waveland
Cutoff Road
Bay St. Louis MS, 39520
Phone Number: [REDACTED]
Email Address: [REDACTED]

Date Submitted:

04/11/2022

DMR Permit Number:
DMR22-000265

Historic DMR Permit Numbers:

DMR File Number:
22-000237

Project Location:

Parcel 139A-0-40-066.000
Bay St. Louis, MS
Hancock County

Latitude: 30.3088
Longitude: -89.33

Do you still need to enter a Project Location?
How will you identify the project location:

Project Information:

Project Name or Title: Embry Boathouse and walking pier

Project Description: This project is for the construction of a boathouse and a walkway connecting both parcels owned by same individual.

Project Purpose and Need: This project will accommodate the safe storage of an additional boat and improve access to the waterway.

Intended Use: Residential

Will the Proposed Project have a Public Benefit?: No

Increased tax base:

Increased employment:

National security benefits:

Improved habitat:

Other:

Does Project area contain any marsh Vegetation?: No

What measures will be taken to reduce detrimental off-site effects to the Coastal Wetlands during and after the proposed activity?: Best Management Practices

Impact Information:

Number of Impact Types **02**

Impact Type: **Boathouse**

New or Maintenance New
Length 30.00
Width 12.00
Method of piling
installation1(Pier, Boathouse,
Pilings) 1. Pile driver
Is this a component of a larger
project? No
Is any portion of this impact
complete? No

Impact Type: **Pier**

New or Maintenance 2 New
Single or multi-pile? 2 01. Single
Length 2 50.00
Width 2 4.00
Number of piers with the same
dimensions? (Pier) 2 1
Method of piling
installation1(Pier, Boathouse,
Pilings) 2 1. Pile driver
Is this a component of a larger
project? 2 No
Is any portion of this impact
complete? 2 No

Additional information relating to the proposed activity

Have any other federal, state, or local agencies issued permits or other types of approvals for the proposed project?:
No

Have any other federal, state, or local agencies denied approval for the proposed project?: No

Project Schedule

Do you know the Proposed Start Date? No

Do you know the Proposed Completion Date? No

Do you know the Estimated Cost of the Project? Yes
\$36,000.00

Adjacent Property Owners:

Application Certified by: Linda Ferrill

Attachment "A" Drawing

James Embry

End of Canal

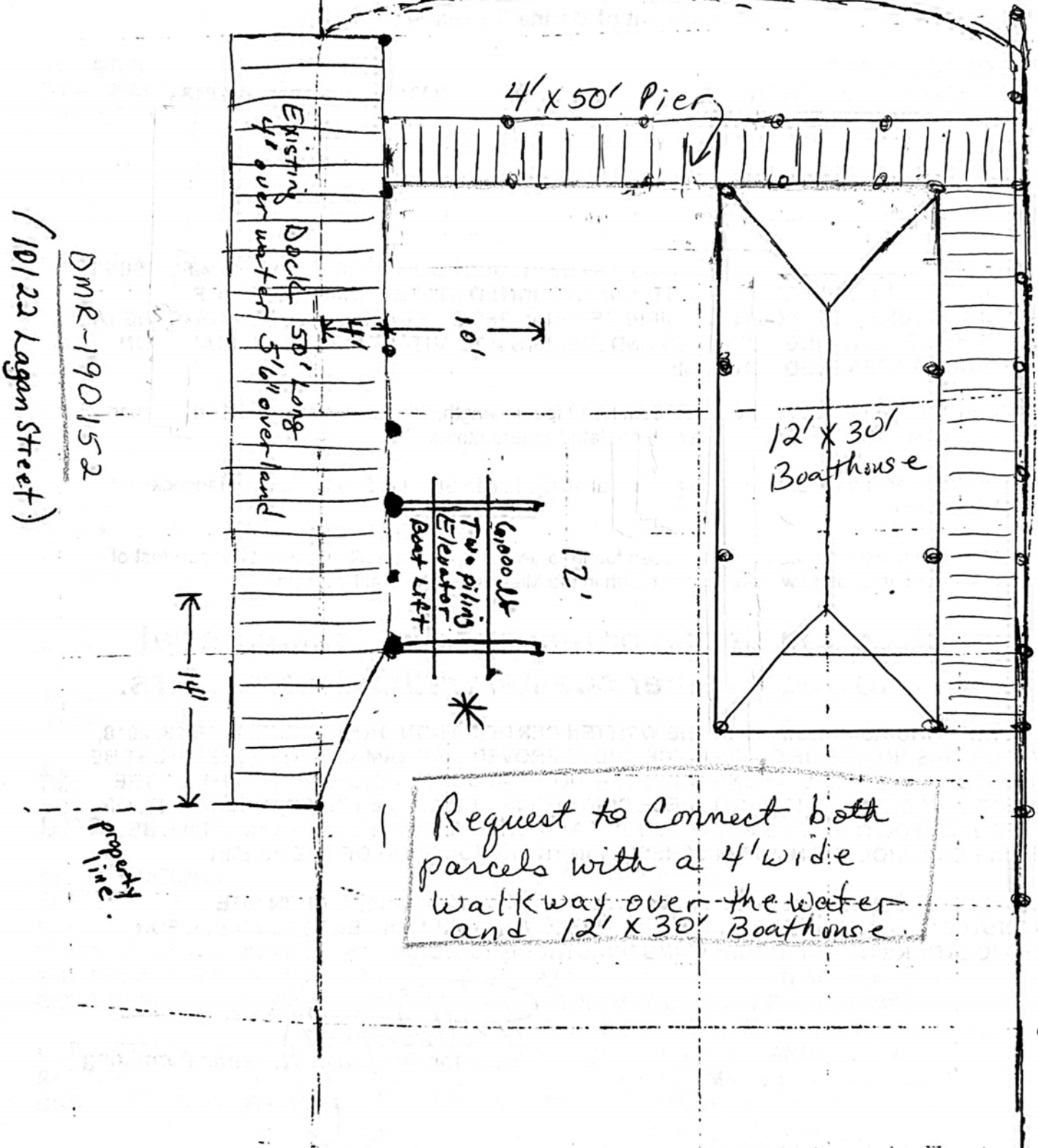

DMR-190152
(10/22 Lagan Street)

DMR-200188

Parcel 139A-0-40-066.000
Louisiana Street