



ENHANCE ★ PROTECT ★ CONSERVE

Mississippi Advisory Commission on Marine Resources

March 21, 2023



ENHANCE ★ PROTECT ★ CONSERVE

Employment, Contracts and Procurement Updates March 21, 2023

Employment Updates

New Hires

- Kyle Wigginton – Started March 16, 2023 – ENR Specialist I – Marine Fisheries (Finfish)

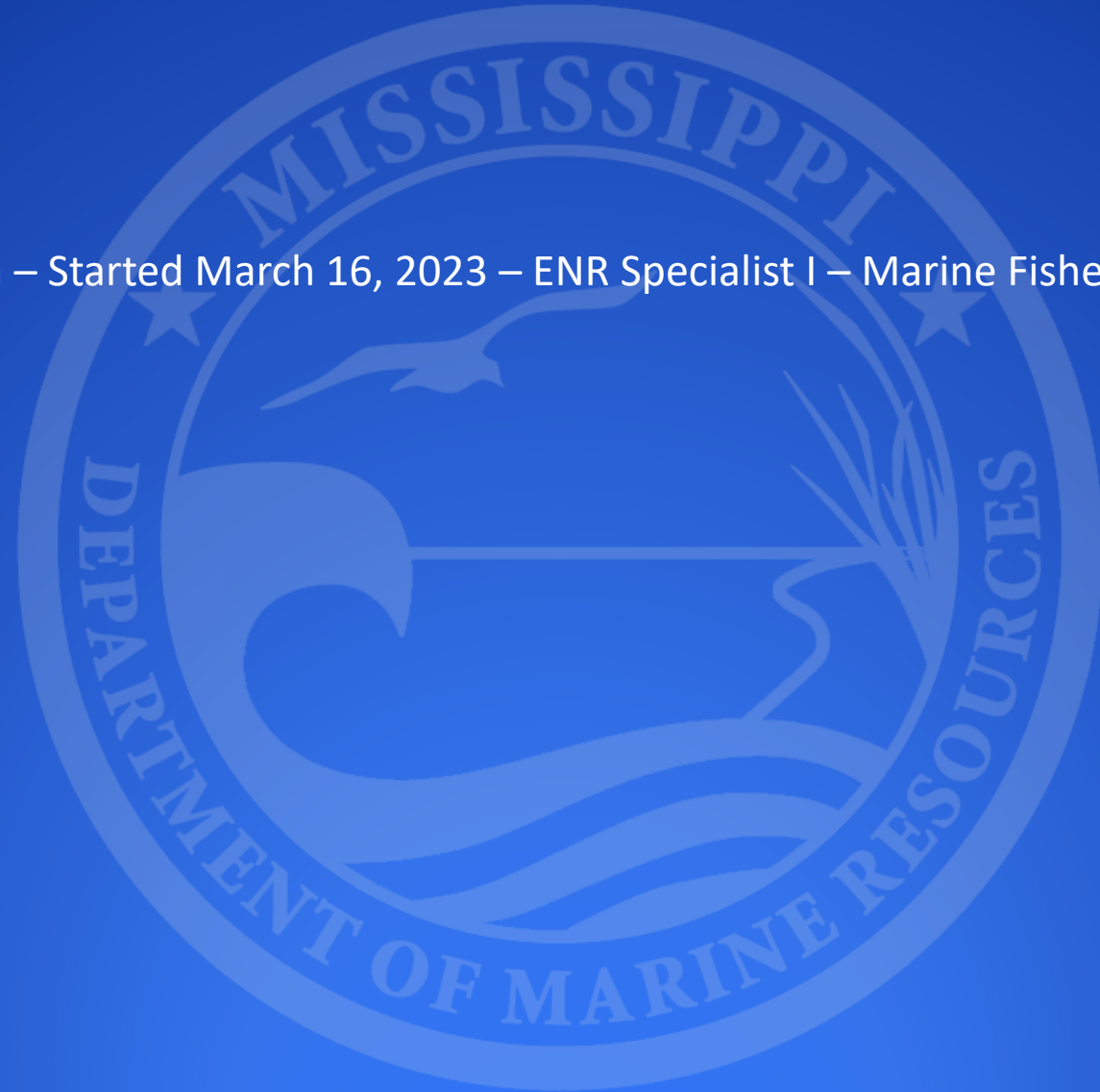

ENHANCE ★ PROTECT ★ CONSERVE



ENHANCE ★ PROTECT ★ CONSERVE

Mississippi Advisory Commission on Marine Resources

March 21, 2023



ENHANCE ★ PROTECT ★ CONSERVE

Actions Update for March 21, 2023 Commission Meeting

Discussed at the February 2023 meeting:

- The Commission recommended and the Director approved the following motions:

1) Approval of the following State Saltwater Finfish Records.

a. Conventional Tackle

1. Mutton Snapper (*Lutjanus analis*)-5 lbs. 8.8 oz. – Johnny Montgomery

b. Fly Tackle

1. Sheepshead (*Archosargus probatocephalus*) – 8 lbs. 1.6 oz. – Doug Borries



ENHANCE ★ PROTECT ★ CONSERVE

Mississippi Advisory Commission on Marine Resources

March 21, 2023

**Request for Permit by:
Jackson County Board of Supervisors
Permit: DMR22-000773**

- **Location: Beach Bayou Ave and Racetrack Rd, Biloxi**
- **Use District: (G) General Use District**
- **Agent: Brown, Mitchell, & Alexander, INC.**

Project Description

- **Creation of Boat Ramp and Associated Piers, Canal, and Parking Area**
 - **Fill:**
 - 0.0108 acre of Coastal Wetlands (tidal marsh) – Boat ramp
 - 0.05 acre of non-tidal wetlands – Parking area
 - **Boat Ramp:** 20' in width; 96 cubic yards fill (unvegetated water bottoms)
 - **Dredging (canal):** 336' x 30'
 - Current depth: 2' MLLW
 - Proposed depth: 4.5' MLLW
 - **Piers (2):** Each 70' x 5'
 - **Breakwater:** 70' vinyl or timber

Race Track Road Launch

Legend

- Beach Bayou Launch
- NOAA-8744117

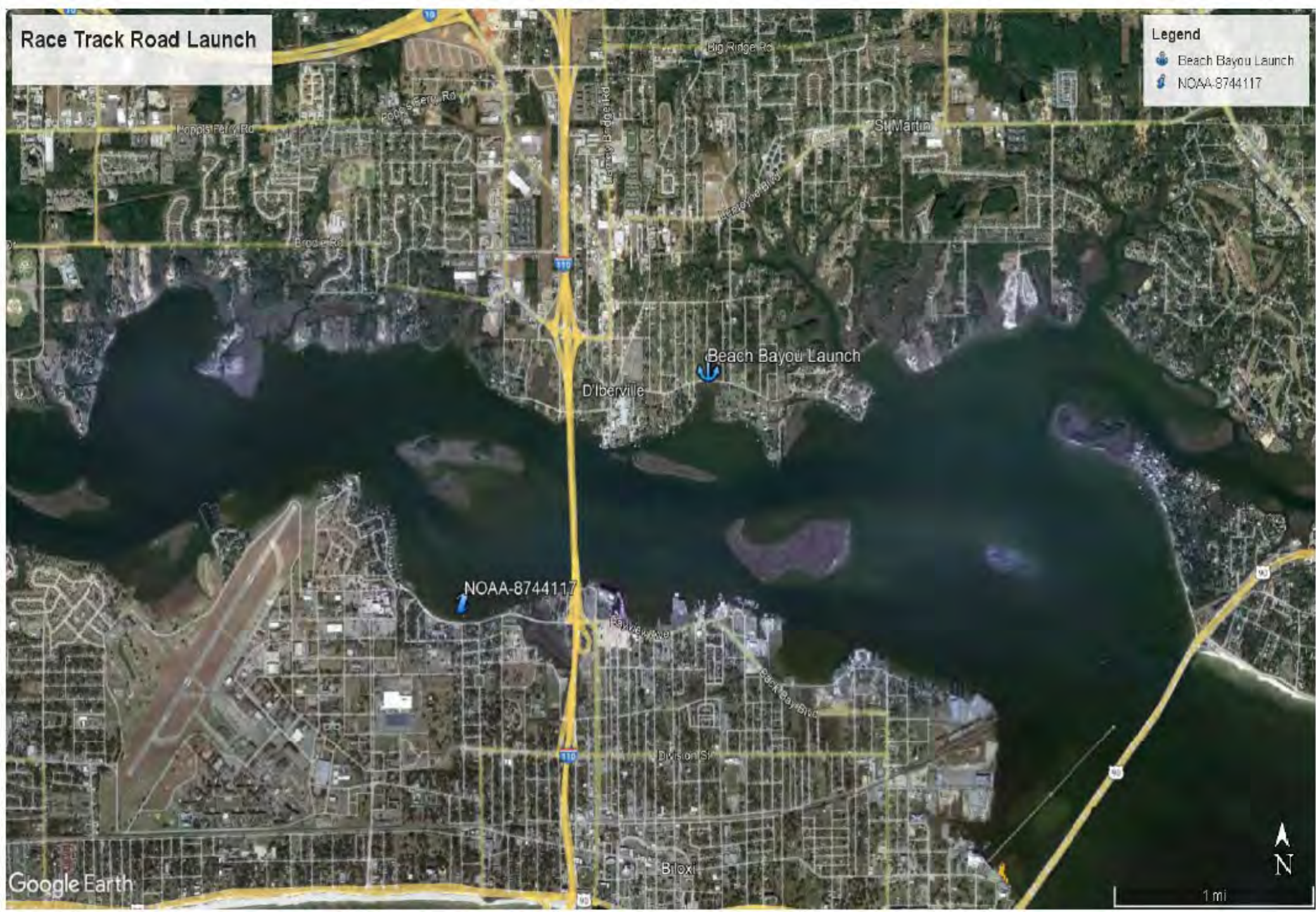

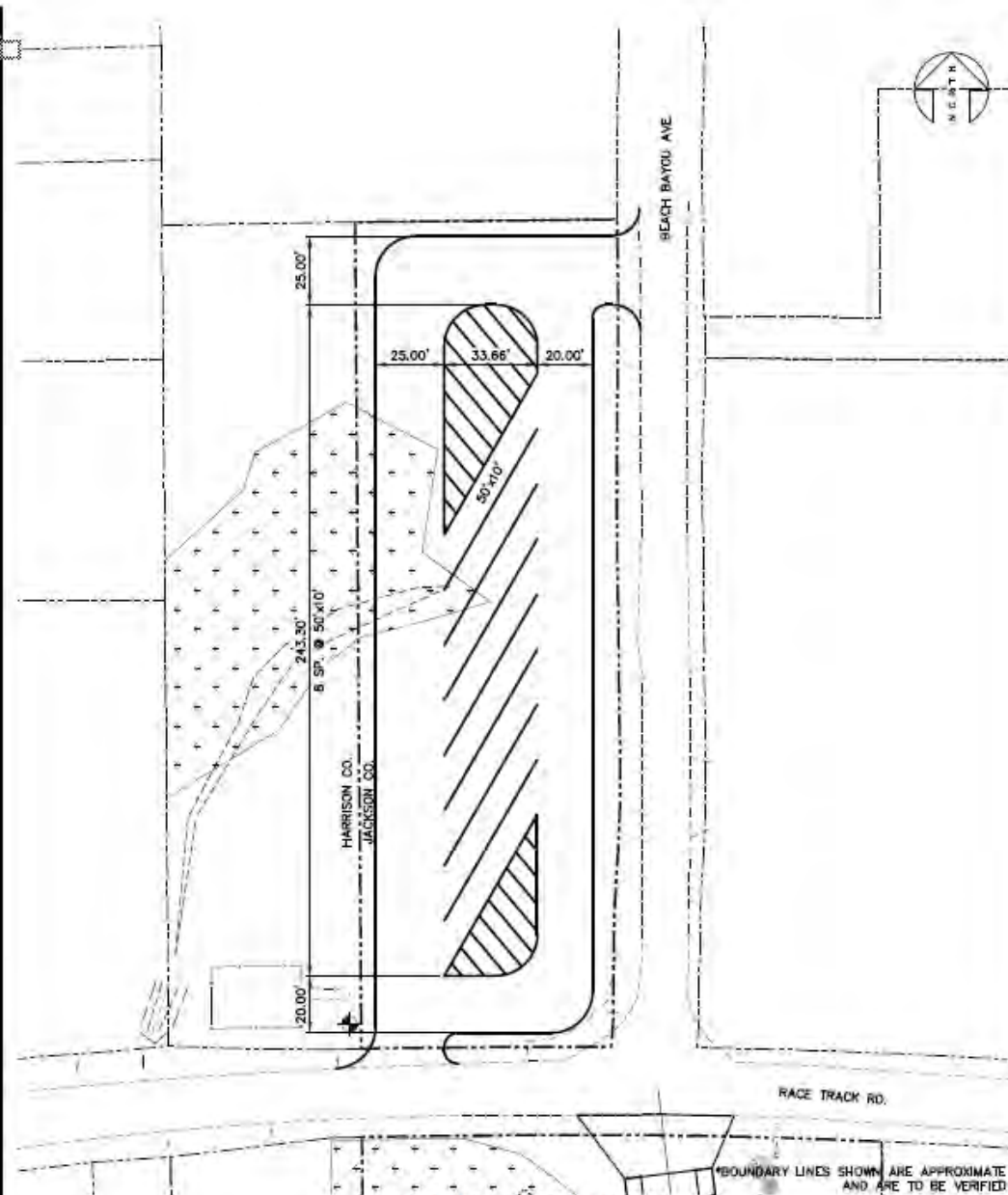

PARKING LOT PLAN

SCALE: 1" = 50'

05/10/2022
 \3777-PERMIT



BROWN, MITCHELL
 & ALEXANDER, INC.
 CONSULTING ENGINEERS

BOAT LAUNCH
 RACETRACK ROAD
 JACKSON COUNTY, MISSISSIPPI

NOT FOR CONSTRUCTION. ALL RIGHTS RESERVED. PROJECT: BOAT LAUNCH, RACETRACK ROAD, JACKSON COUNTY, MISSISSIPPI. PREPARED BY: BROWN, MITCHELL & ALEXANDER, INC. DATE: 08/01/2022. SCALE: AS SHOWN. SHEET: 1 OF 2. SITE LAYOUT PLAN/RAMP SECTION/DREDGING SECTION.

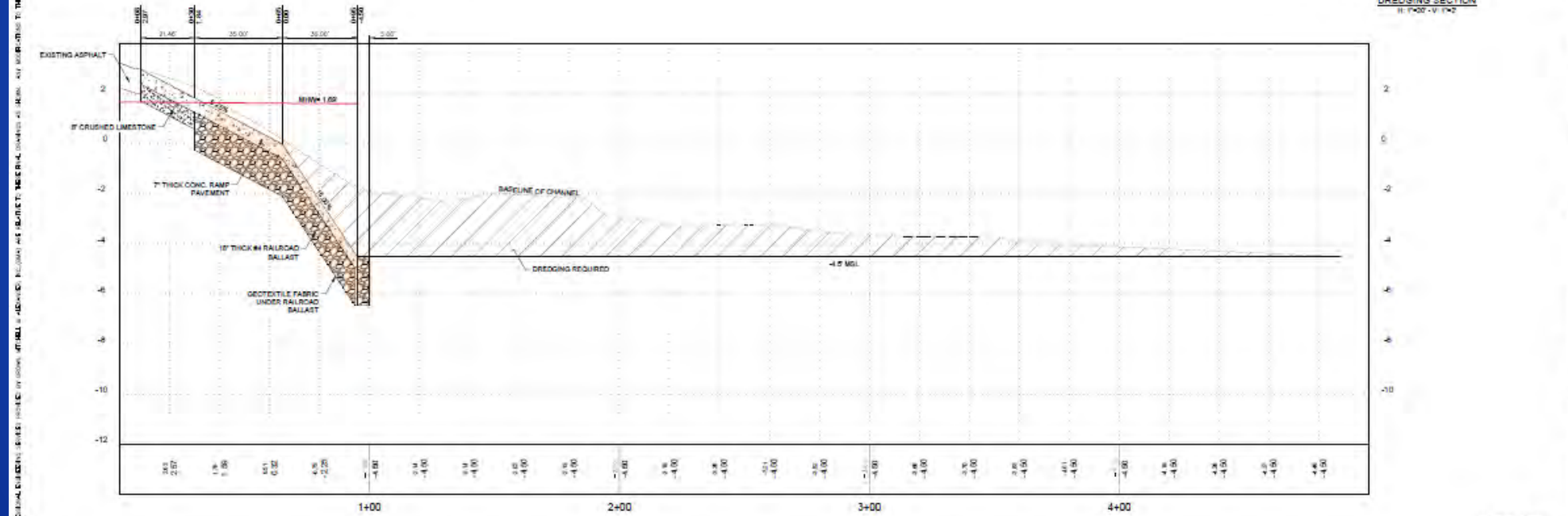
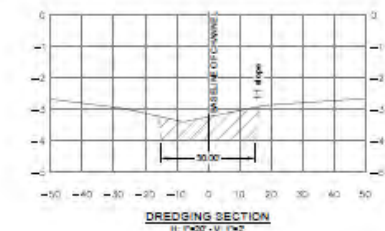
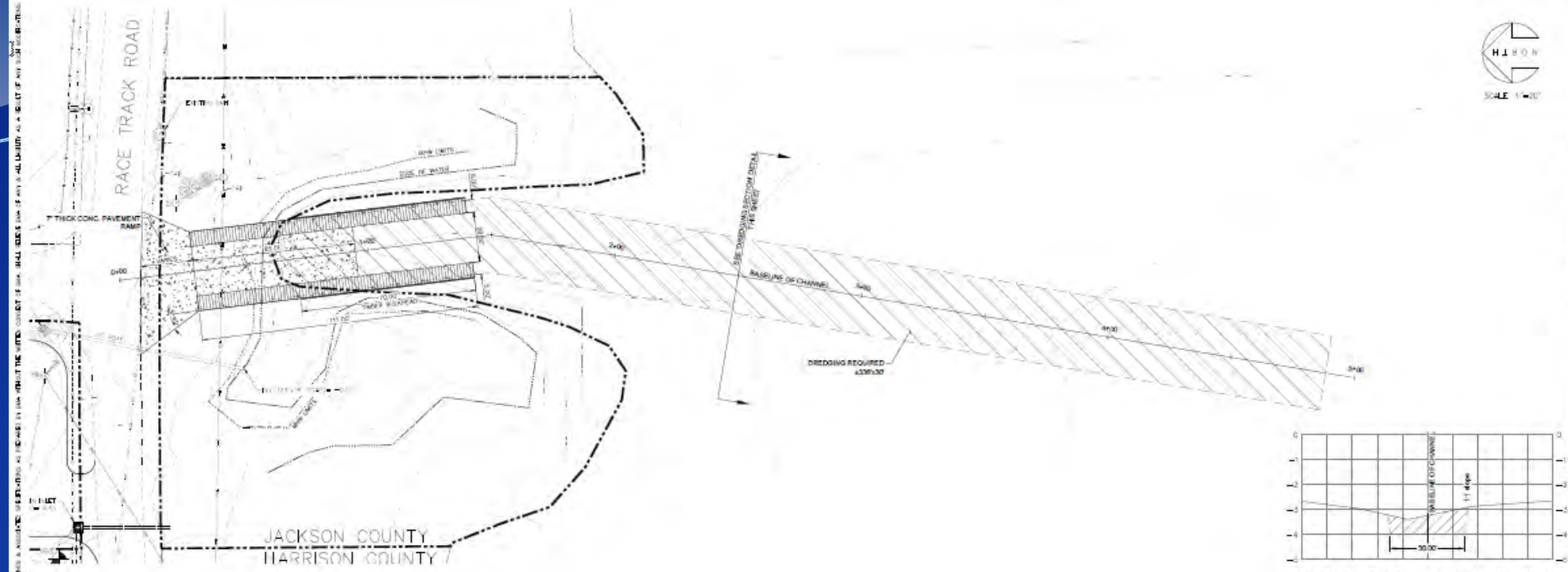

BOAT LAUNCH
RACETRACK ROAD
JACKSON COUNTY, MISSISSIPPI

BOAT LAUNCH
RACETRACK ROAD
JACKSON COUNTY, MISSISSIPPI

BOAT LAUNCH
RACETRACK ROAD
JACKSON COUNTY, MISSISSIPPI

BROWN, MITCHELL & ALEXANDER, INC.
CONSULTING ENGINEERS

bma

PRELIMINARY

C-121

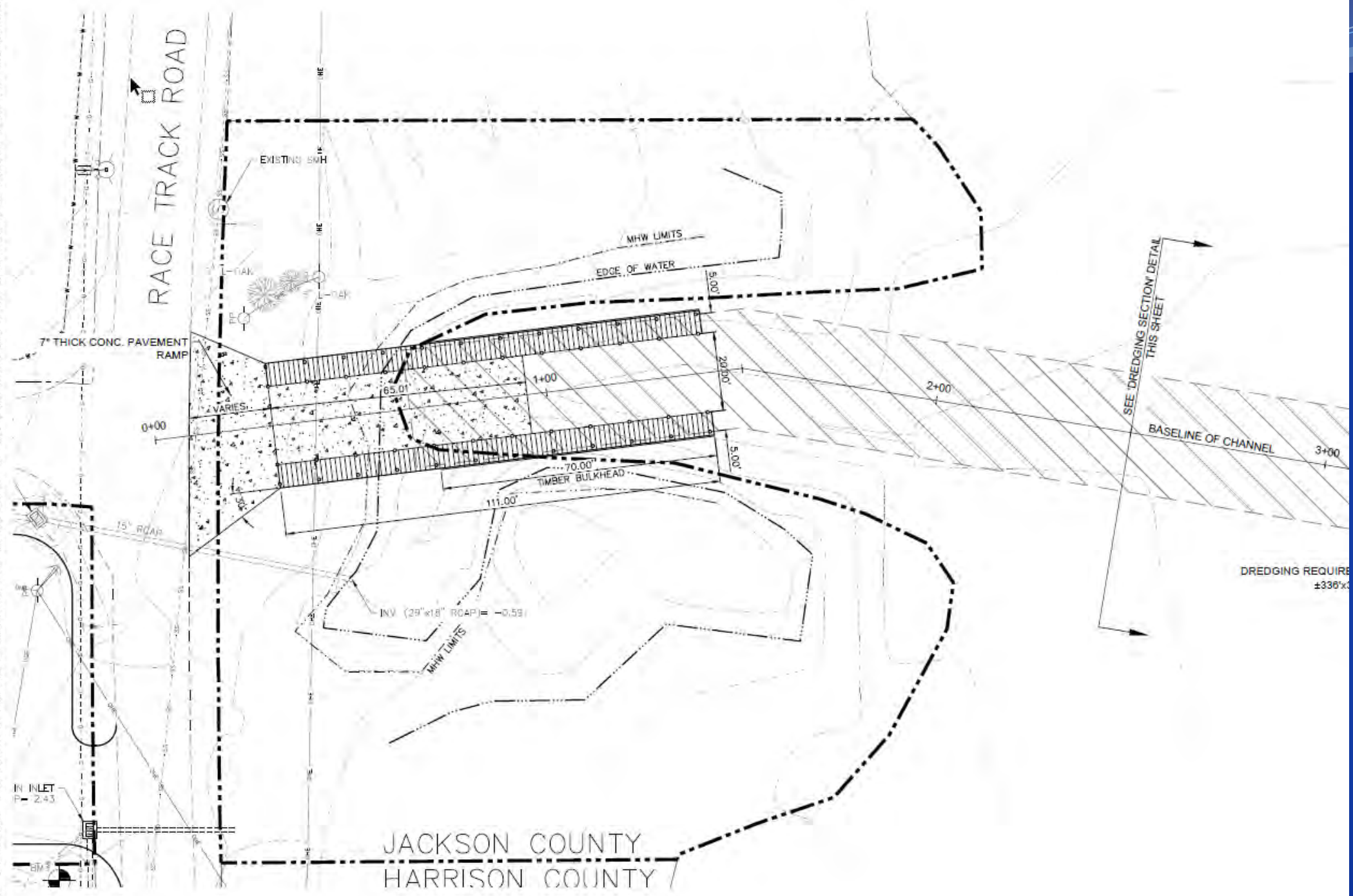

DRAWINGS & ASSOCIATED SPECIFICATIONS AS PREPARED BY BMA WITHOUT THE WRITTEN CONSENT OF BMA, SHALL RELIEVE BMA OF ANY & ALL LIABILITY AS A RESULT OF ANY SUCH MODIFICATIONS.



Proposed Impacts & Revegetation Efforts

Area For Proposed Revegetation – $\pm 1,587$ sq. ft.
Area of Proposed Impacts – ± 472 sq. ft.

Legend

-  Area For Revegetation
-  Wetland Impact Area B



Proposed Vegetation Impacts & Remediation Efforts



BROWN, MITCHELL
& ALEXANDER, INC.

CONSULTING ENGINEERS

401 Cowan Road,
Suite A,
Gulfport, MS 39507
(228) 866-7612

131 Rue Magnolia
Blvd., MS 39530
(228) 436-7612

3221 Market Street

Applicable Decision Factors

- **c) Variance to the MS Coastal Program...**
 - **Miss. Admin. Code Title 22, Part 23, Chapter 8, Section 101.01, 114.01, and 117.3**
 - 101.01..“(Boat Ramps) Must be located in areas which do not require the destruction of sensitive coastal wetlands...”
 - 114.01.. “Permanent filling of coastal wetlands below the mean high tide line because of potential adverse and cumulative environmental impacts is not authorized”
 - 117.3..“A minimum ten-foot (10-foot) buffer must be maintained between dredging/excavation and any wetlands”
 - **This variance request was justified under Miss. Admin. Code Title 22, Part 23, Chapter 8, Section 118.04**
 - states “The activity requires a waterfront location; there is a significant public benefit in the activity; and a public hearing has been held.”



Applicable Decision Factors continued

- e) The extent to which the proposed activity affects biological integrity of coastal wetlands...
- **Mitigation Proposed**
 - 3:1 ratio: 1,587 square feet
 - Debris removal: Litter cleanup
 - Planting of *S. alterniflora* and *J. roemerianus*
 - Will transplant impacted vegetation
 - In accordance with MDMR's Marsh Restoration and Creation Guidelines

Proposed Impacts & Revegetation Efforts

Area For Proposed Revegetation – $\pm 1,587$ sq. ft.
Area of Proposed Impacts – ± 472 sq. ft.

Legend

-  Area For Revegetation
-  Wetland Impact Area B



Proposed Vegetation Impacts & Remediation Efforts



**BROWN, MITCHELL
& ALEXANDER, INC.**

CONSULTING ENGINEERS

401 Cowan Road,
Suite A,
Gulfport, MS 39507
(228) 866-7612

131 Rue Magnolia
Blvd., MS 39530
(228) 436-7612

3221 Market Street

Applicable Decision Factors

continued

- I) Comments...
 - Notification of the project appeared in *The Sun Herald* on January 18, January 22, and January 29, 2023.
 - Notification was also posted to the MDMR website on January 18, 2023, to present
 - MDEQ: No Comments
 - MDAH: No Objection
 - MS DWFP: No Comments
 - MS SOS: Rent exempt public trust tidelands lease is required
 - A public hearing was held on February 23, 2023 at 5:30 p.m. and no comments were received

Recommendation

- The staff of the Department of Marine Resources has conducted a thorough evaluation of the project and has made findings on the decision factors in accordance with the Mississippi Coastal Program (MCP). Based on the results of these findings, it has been determined that the project is consistent with the MCP because the project serves a higher public purpose.
- Staff requests a motion that the Commission recommend to the Executive Director:
 - Approval of the Requested Variances
 - Approval of the proposed mitigation plan
 - Approval of the Requested Permit



ENHANCE ★ PROTECT ★ CONSERVE

Mississippi Advisory Commission on Marine Resources

March 21, 2023



ENHANCE ★ PROTECT ★ CONSERVE

Mississippi

Department of Marine Resources

Agency Financial Results
as of February 28, 2023

Key Metrics:

- State Revenue of \$5.0M
- Agency Revenue of \$21.4M
- State Net Income of (\$116K)
- Agency Net Income of (\$1.6M)

MISSISSIPPI DEPARTMENT OF MARINE RESOURCES

Income Statement - Fiscal Year 2023

As of February 28, 2023

	Federal : GOMESA PHII: NFWF:		Operating		
	State	Non-Federal:	Subtotal	Tidelands	Total DMR
Revenue:					
Off-road Fuel Tax	3,050,000	-	3,050,000	-	3,050,000
Federal/NonFederal Grants	116,145	3,926,889	4,043,034	-	4,043,034
Sales Revenue	842,617	4,603	847,220	1,973	849,193
Indirect Cost Recovery	755,436	-	755,436	-	755,436
Other Revenue	275,805	1,843,979	2,119,784	10,590,616	12,710,399
Current Budget Year Revenue:	5,040,003	5,775,471	10,815,474	10,592,589	21,408,062
Expenditures:					
Salaries, Wages, Fringe	4,080,698	2,314,828	6,395,525	736,295	7,131,821
Travel	18,797	39,744	58,541	6,406	64,947
Contractual Services	697,687	1,518,955	2,216,642	521,656	2,738,299
Commodities	235,105	990,297	1,225,401	87,126	1,312,527
Other than Equipment	10,072	-	10,072	15,109	25,181
Equipment	66,367	246,219	312,586	58,744	371,330
Vehicles	38,892	69,619	108,511	220,285	328,796
Subsidies, Loans, and Grants	9,067	6,466,724	6,475,791	4,609,266	11,085,057
Current Budget Year Expenditures:	5,156,685	11,646,386	16,803,071	6,254,886	23,057,957
Current Budget Year Net Income/(Loss):	\$ (116,682)	\$ (5,870,915)	\$ (5,987,597)	\$ 4,337,702	\$ (1,649,895)

Financial Budget Comparison

- After eight months of Fiscal Year 2023:

MISSISSIPPI DEPARTMENT OF MARINE RESOURCES
2023 Budget Comparison
As of February 28, 2023

	<i>Actual Year to Date Expenditures</i>			<i>Budget Year Totals</i>			<i>Percent Remaining</i>		
	Operating	Tidelands	Total	Operating	Tidelands	Total	Operating	Tidelands	Total
Expenditures:									
Salaries, Wages, Fringe	\$ 6,395,525	\$ 736,295	\$ 7,131,821	\$ 12,324,762	\$ 1,672,239	\$ 13,997,001	48.1%	56.0%	49.0%
Travel	58,541	6,406	64,947	168,711	25,000	193,711	65.3%	74.4%	66.5%
Contractual Services	2,216,642	521,656	2,738,299	7,793,250	1,651,000	9,444,250	71.6%	68.4%	71.0%
Commodities	1,225,401	87,126	1,312,527	3,086,978	360,000	3,446,978	60.3%	75.8%	61.9%
Other than Equipment	10,072	15,109	25,181	139,522	15,109	154,631	92.8%	0.0%	83.7%
Equipment	312,586	58,744	371,330	669,605	175,000	844,605	53.3%	66.4%	56.0%
Vehicles	108,511	220,285	328,796	170,000	250,000	420,000	36.2%	11.9%	21.7%
Wireless Devices	-	-	-	6,250	-	6,250	100.0%	0.0%	100.0%
Subsidies, Loans, and Grants	6,475,791	4,609,266	11,085,057	99,833,422	8,306,899	108,140,321	93.5%	44.5%	89.7%
Total Expenditures:	\$ 16,803,071	\$ 6,254,886	\$ 23,057,957	\$ 124,191,500	\$ 12,455,247	\$ 136,647,747	86.5%	49.8%	83.1%

- Operating Funds have 86.5% of Budget remaining
- Tidelands Trust Fund has 49.8% of Budget remaining



ENHANCE ★ PROTECT ★ CONSERVE

Mississippi Advisory Commission on Marine Resources

March 21, 2023



ENHANCE ★ PROTECT ★ CONSERVE

State Saltwater Finfish Records

Trevor Moncrief

March 21, 2023

The background features a large, faint, circular seal of the Mississippi Department of Marine Resources. The seal contains the text "MISSISSIPPI" at the top and "DEPARTMENT OF MARINE RESOURCES" at the bottom, separated by two stars. The central image of the seal depicts a bird in flight over stylized waves.

All Tackle Record

ENHANCE ★ PROTECT ★ CONSERVE

All Tackle (Electric Reel) Fishing Record

Blueline Tilefish
Caulolatilus microps

Old Record: 2 lbs. 13 oz.
New Record: 12 lbs. 5.6 oz.

Angler: Joshua Taylor

ENHANCE ★ PROTECT ★ CONSERVE



ENHANCE ★ PROTECT ★ CONSERVE



ENHANCE ★ PROTECT ★ CONSERVE

The logo of the Mississippi Department of Marine Resources is a circular seal. It features a central illustration of a fish jumping out of stylized waves. Above the fish, the word "MISSISSIPPI" is written in an arc, flanked by two stars. Below the fish, the words "DEPARTMENT OF MARINE RESOURCES" are written in an arc. The entire seal is rendered in a light blue color against a darker blue background.

Conventional Tackle Record

ENHANCE ★ PROTECT ★ CONSERVE

Conventional Tackle Fishing Record

Gulf Smoothhound
Mustelus sinusmexicanus

New Record: 23 lbs. 15.99 oz.

Angler: Cooper Seibert



ENHANCE ★ PROTECT ★ CONSERVE



ENHANCE ★ PROTECT ★ CONSERVE

The background features a large, faint, circular seal of the Mississippi Department of Marine Resources. The seal contains the word "MISSISSIPPI" at the top, a bird in flight in the center, and "DEPARTMENT OF MARINE RESOURCES" at the bottom. The entire slide has a blue background with wavy lines at the top.

Motion to Recommend Adoption of New State Records

ENHANCE ★ PROTECT ★ CONSERVE



ENHANCE ★ PROTECT ★ CONSERVE

Mississippi Advisory Commission on Marine Resources

March 21, 2023



ENHANCE ★ PROTECT ★ CONSERVE

Grand Bay NERR Update

Join Us at the Celebrate the Gulf Marine Education Festival!

April 1, 2023

War Memorial Park, Pass Christian, MS



Celebrate the Gulf Marine Education Festival – April 1, 2023

This year we have 243 entries in the student art contest and 11 entries for the Student Science Showcase.

We expect over 5,000 people to enjoy the festival! Join us!



Celebrate the Gulf Marine Education Festival
A Showcase of Mississippi's Coastal Habitats and Heritage
Pass Christian, Mississippi • April 1, 2023





ENHANCE ★ PROTECT ★ CONSERVE

Mississippi Advisory Commission on Marine Resources

March 21, 2023